



ENG P02
P03-10
P 11
P 11
QUIT

ESC

OWNER'S GUIDE BOOK

RNX 316

CARAN D'ACHE, MAISON DE HAUTE ÉCRITURE
THE RNX.316 COLLECTION
STAINLESS STEEL: A NEW MATERIAL
INTERNATIONAL GUARANTEE

CARAN d'ACHE
GENÈVE



CARAN D'ACHE, MAISON DE HAUTE ÉCRITURE

**YOU ARE NOW THE OWNER OF A CARAN D'ACHE
WRITING INSTRUMENT AND WE THANK YOU.**

With its priceless legacy of expertise, Caran d'Ache is keeping the art of writing alive and well. In the great Swiss manufacturing tradition, it works with passion and rigour to create exceptional products. Caran d'Ache writing instruments are recognised over the world for their excellence and their daring combination of technology and aesthetics. They are technical marvels that have a strong emotional appeal. By combining originality in the use of materials with perfection of form they make writing by hand a genuinely refined experience. When you offer a Caran d'Ache luxury writing, drawing instrument or accessory, you are choosing a symbol of prestige and style that affirms your love of beautiful things.

THE RNX.316 COLLECTION

**THE RNX.316 FOUNTAIN PEN
USING FOR THE FIRST TIME.**

When you use your fountain pen for the first time, we suggest that you write a few lines in order to start the ink flow. Alternatively, place a piece of absorbent paper on the nib for 10-15 seconds. Otherwise, a temporary surplus flow of ink may result.

PRECAUTIONS DURING USE.

Use only Caran d'Ache ink or cartridges.
Do not dismantle any part of the writing block.

The RNX.316 is fitted with an innovative system for changing the ink cartridge or pump reservoir. When you change the ink cartridge, hold the **writing bloc** and unscrew the body of the pen. **Always keep the pen pointing upwards to avoid dropping the writing block.**

To open. Take off the cap. Hold the writing block. See diagram **A**

To close. Line up the writing block and the body. See diagram **B**

Using a reservoir pump.
See diagram **C**

Fitting a cartridge. See diagram **D**
Care of the writing block (page 18)

04
05

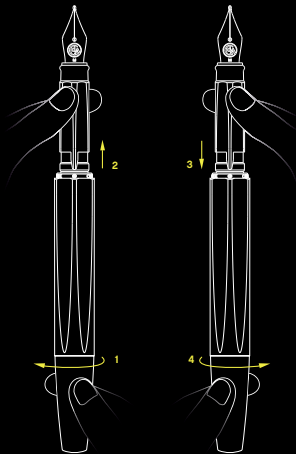

A

B

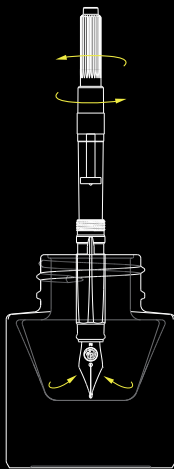

C



D

CARE OF THE WRITING BLOCK

IF YOU DO NOT USE YOUR FOUNTAIN PEN RNX.316 FOR SOME TIME, THE INK MAY DRY INSIDE THE WRITING BLOCK.

Take out the cartridges, or the ink pump, which you empty and refill on the writing block.

Immerse the whole nib in a container of distilled water (never use detergents or any other cleaning materials).

Turn the knurled section clockwise until the reservoir is full, then anti-clockwise to expel the water through the writing block.

Repeat this operation until the expelled water is clear. Remove the water from the writing block by pressing absorbent paper on the split of the nib.

If you do not plan to use your pen for a prolonged period, do not refill it with ink after cleaning.

If any problem should arise, please contact Caran d'Ache after-sales service.

ROLLERPEN RNX.316

CHANGING THE CARTRIDGE.

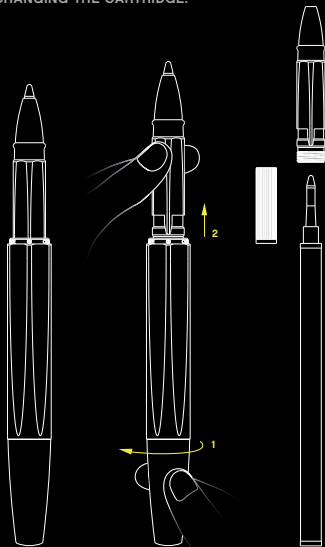

BALLPOINT PEN RNX.316

CHANGING THE CARTRIDGE.

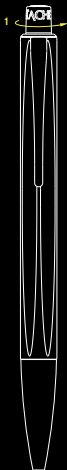

CARAN D'ACHE GOLIATH GIANT CARTRIDGES

08
09

With its steel point containing a free-turning ball in tungsten carbide that provides a clean blot-free line, the legendary Goliath giant cartridge delivers up to 600 A4 pages of handwriting.

Available in 3 writing widths.

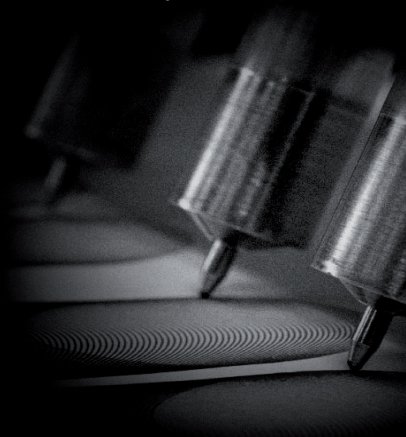

MECHANICAL PENCIL RXN.316

FILLING THE RESERVOIR
AND REPLACING THE ERASER.

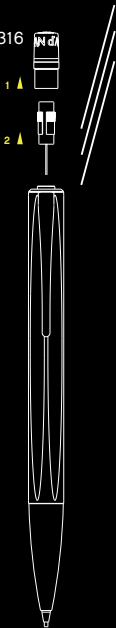

STAINLESS STEEL: A NEW MATERIAL

The strength and flexibility of the steel used in the RXN.316 guarantees that the writing instrument can withstand the stress of repeated use. Its fundamental mechanical properties are enhanced by its purity, the result of high-quality polishing. Following the example of Fine Watchmaking, Caran d'Ache has adopted stainless steel in order to offer more than a writing instrument: an experience.

INTERNATIONAL GUARANTEE

Your Caran d'Ache writing instrument has been manufactured to the highest standards and is covered by a lifetime guarantee against all material and manufacturing defects or a two-year guarantee in the case of models decorated with Swarovski crystals. If any defect becomes apparent, your instrument will be repaired or exchanged for another of the same value upon presentation of this certificate, duly completed, to Caran d'Ache or one of its distributors. The guarantee does not cover normal wear, accidental damage, damage arising from improper use or shocks, or loss. Furthermore, the guarantee does not cover leads, erasers, ink refills, personalised decoration or the use of components other than those recommended by Caran d'Ache. Caran d'Ache will carry out any repairs that are not covered by the guarantee upon your acceptance of a cost estimate. In the event of defects, any dismantling or repair carried out by persons other than authorised Caran d'Ache personnel invalidates the guarantee.



CARAN d'ACHE
GENEVE

CARANDACHE.COM